

Get Started Guide

MUST READ

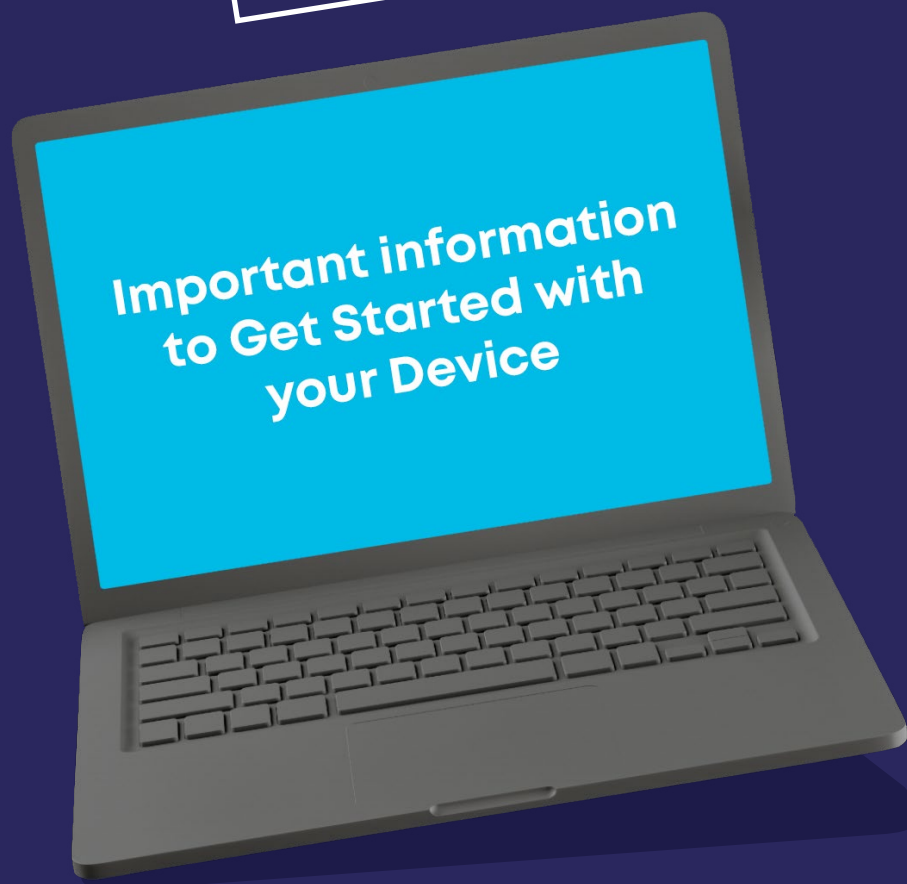

Introduction

Hello and welcome to your **Get Started Guide** for your new device for school. Please follow these easy steps to activate your device and start learning.



In this pack you will find important information to set up your device for learning in the following sections;

Step 1: Power on and Get Started

Step 2: Connect to Wi-Fi

Step 3: Terms of Service

Step 4: School Enrolment

Step 5: Sign in and Set Password

Step 6: Sign into your eBooks



You will also find information and links to training, videos and resources included in your bundle to help you get started with your device for learning.

Getting Started

You will need these before you get started.



Wriggle Information Sheet
School Details

Important Information.
Keep this Page Safe

You will need to reference this Information Sheet as you follow your Get Started Guide

A. First Name, Last Name **Order Number**
Asus CR1100 Chromebook 4GB/64GB

B. * Your Google Account:
*** Your Temporary Google Account Password:**

C. Ebook Username:
Ebook Password:

Thank you for ordering from Wriggle Learning.

Your Order: 71

<input type="checkbox"/> CR1100FKA-BP0166-3Y Asus CR1100 Chromebook 4GB/64GB	<input type="checkbox"/> AS-ESL-BR11-BLK Asus CR1100 Case
<input type="checkbox"/> MHJF3B/A Apple 20W Plug	<input type="checkbox"/> MX532ZM/A Apple Airtag
<input type="checkbox"/> INC016myBK Belkin Multi Device Adaptor	<input type="checkbox"/> XWH-PMS2-13 MagSafe Powerbank 5000 mAh (Phone Only)
<input type="checkbox"/> XWH-XTW-03 X-Twists Earpods	<input type="checkbox"/> MV7N2ZM/A Apple AirPods with Charging Case
<input type="checkbox"/> JBLT520BTBLKEU JBL Wireless On Ear Headphones	<input type="checkbox"/> 8951 PanzerGlass Spray 30ml
<input type="checkbox"/> TBB636GL Sagano EcoSmart Backpack 16"	<input type="checkbox"/> AMW50EU Wireless Mouse

Wriggle Information Sheet (located inside the box). You will need to refer to this Information Sheet as you go through your guide.



Your Device



Case



Charger

Step 1.

Power on and Get Started

1.1 Plug in your device to your charger.

To turn on your device, lift the screen, press and hold down the power button. This may be located on the side of your device or on the top right corner of your keyboard, depending on your device, and looks like the icon to your right.



Please keep your device connected to the charger for the initial setup. Click **Get Started**, when it shows up on your screen.

Need help?

Scan the QR code or follow the link to watch a short video for steps.
bit.ly/setupmychromebook



Step 2.

Connect to Wi-Fi

2.1 You will now be asked to connect to an available Wi-Fi network. Please select your Wi-Fi network, enter the password for this Wi-Fi network, and click **Connect**.

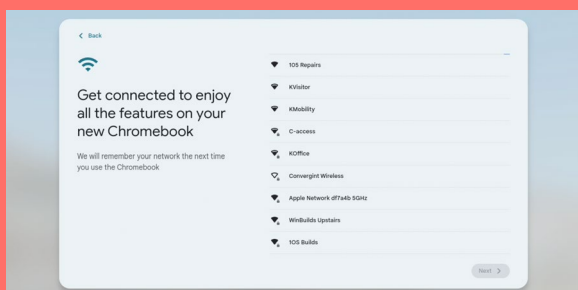

Step 3.

Terms of Service

3.1 When you see the Google Terms of Service come up, click **Accept and Continue**.

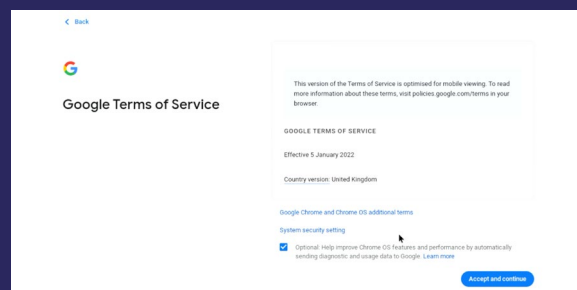

Step 4.

School Enrolment

4.1 When your enrolment is complete, and the following message appears, click **Done**.

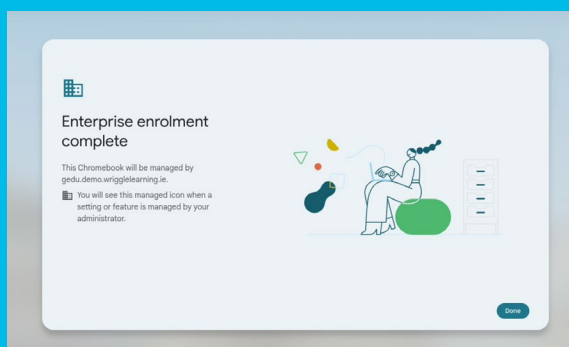

Step 5.

Sign in and set a password

5.1 Sign in with your Google email address and temporary password, which is located on Section B of your Wriggle information sheet. Now click **Next**.

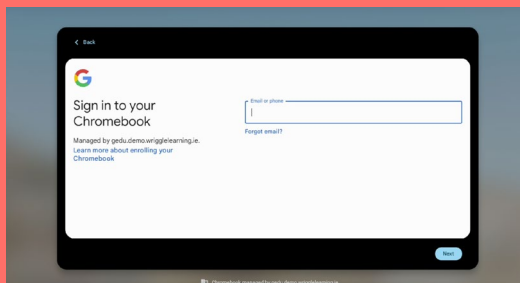

B. * Your Google Account:

* Your Temporary Google Account Password:

5.2 You may be prompted at this point to change the temporary password and set the new password on your device. Please ensure you create a strong password that you will remember.

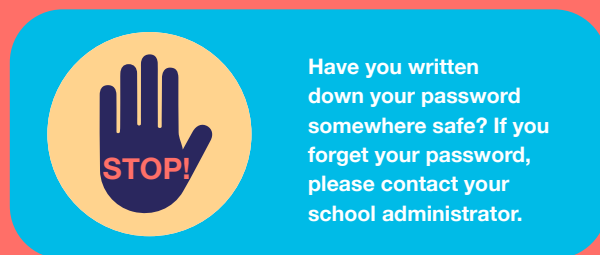
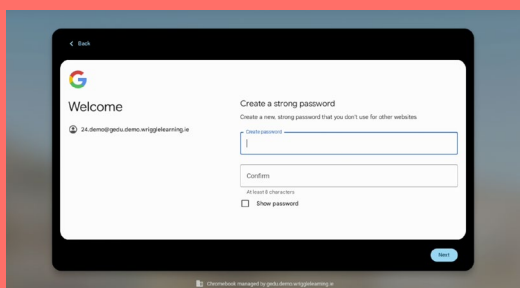

Step 6.

Sign into your eBooks

Important: If you receive physical textbooks from your school, you will be able to download a digital eBook for each of your textbooks to your device. We have made this process easier for you by creating the account you can use to log into your eBook Apps.

Schools may have different processes around physical books and eBooks, so please check with your school if you are unsure.



Need help?

Scan the QR code or follow the link to watch a short video for steps.
bit.ly/ebooksdownloadchromebook

Every publisher is slightly different. Please scan the QR code or follow the link to watch the video guides before you attempt to log in.

Once you have followed all videos and guides for each of your books' publishers, you may now follow Step 6.1 to log in.

6.1 You can access your eBook apps via the PlayStore. Please find your eBook login details on **Section C** of your Wriggle Information Sheet.

C. **Ebook Username:**

Ebook Password:

wriggleConnect

family

Now that your device is setup, you will need to access our online training platform.

This platform is designed to support you with guidance on downloading and using eBooks, device settings, managing updates and lots more!

To gain access to the platform you will need to follow these steps:

- Go to the inbox of the email account (parent/guardian) that was used to purchase the device bundle on the **Wriggle Store**.
- You will recently have received an email from **Wriggle Connect** advising you to activate your account (you may need to check your junk/spam filter in case it has been caught in there).
- Once you have activated your account and set a password, you will now be able to access **Wriggle Connect!** If you have any issues with signing in, you can simply click the **“Forgot your password?”** icon on the login screen at www.family.wriggleconnect.ie



4 Courses to Help You Get Started

Scan the QR codes below with your smart phone or follow the links to access the courses below.

1



bit.ly/chromebookgoogleclassroom
Google Classroom on Chromebook
for Students

2



bit.ly/googledrivechromebook
Google Drive on Chromebook for
Students

3



bit.ly/chromebookgmail
Gmail on Chromebook
for Students

4



bit.ly/cybersafekidsbtb
CyberSafe Kids - Back to Basics

To get started, carefully remove the case from its packaging and make sure you have all the included pieces. Before attaching it, take a moment to understand how each part fits. **This case is designed to stay on for the life of the device,** so it's important to install it correctly the first time.

Scan the QR code below to watch a quick video that walks you through the installation step-by-step. The video shows exactly how to fit the case, so it locks securely into place. Once installed, check that all corners and edges are properly snapped in. You should not remove the case again — it's built to protect the device long-term.





wriggle.ie/support/

wriggle.ie

info@wrigglelearning.ie

